



SERVICE PARTS LIST

BULLETIN NO.
54-38-3010

| SPECIFY CATALOG NO. AND SERIAL NO. WHEN ORDERING PARTS | | REVISED BULLETIN | DATE |
|--|----------------|---------------------|-------------|
| M12™ FUEL™ ORBITAL DETAIL SANDER | | | July 2022 |
| CATALOG NO. | 2531-20 | STARTING SERIAL NO. | N03A |
| WIRING INSTRUCTION | | | |

EXAMPLE:
 00 0 Component Parts (Small #) Are Included
 When Ordering The Assembly (Large #).

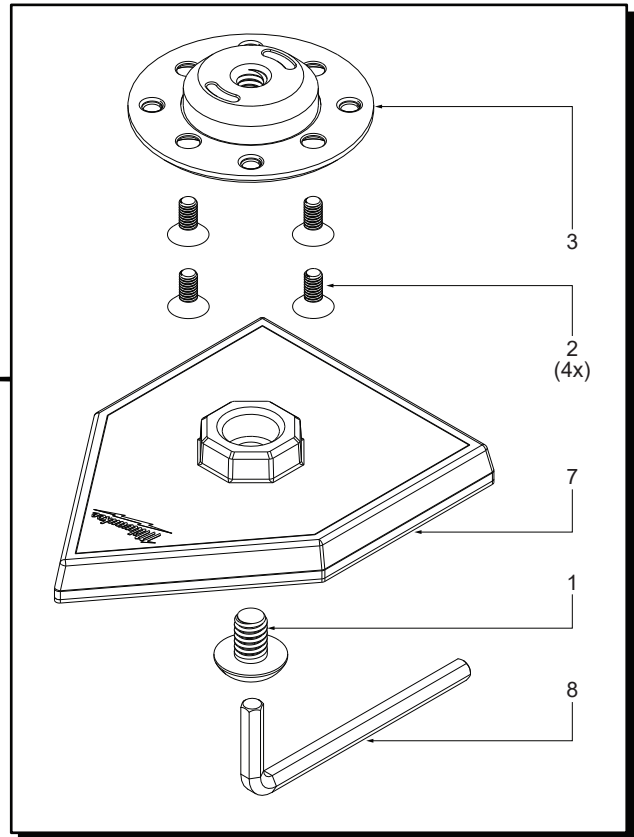

| FIG. | PART NO. | DESCRIPTION OF PART | NO. REQ. |
|------|------------|---|----------|
| 1 | 06-82-0040 | 1/4-20 x 9mm UNC-2A TH Hex Screw | (1) |
| 2 | 06-81-0028 | M3.5 x 8mm Flat Head T-20 Machine Screw | (4) |
| 3 | 28-10-2531 | Pad Attachment | (1) |
| 4 | 42-55-2531 | Contractor Bag (Not Shown) | (1) |
| 5 | 42-70-0058 | Housing Connection Clip | (1) |
| 6 | 12-20-2518 | Service Nameplate (Not Shown) | (1) |
| 7 | 49-36-2531 | Replacement Sanding Pad (Accessory) | (1) |
| 8 | 45-96-0031 | 1/4" Hex Wrench | (1) |

FIG. NOTES
 6 A clean, dry surface is essential for proper performance for any adhesive system. Area intended for application of any adhesive label or nameplate must be prepared by cleaning with isopropyl alcohol. The solvent is to be applied with a clean, lint free applicator and the surface allowed to dry before applying the label or nameplate.

| SCREW TORQUE SPECIFICATIONS | | | | |
|-----------------------------|------------|----------------|-------------|----------|
| FIG. | PART NO. | WHERE USED | SEAT TORQUE | |
| | | | (KGF/CM) | (IN/LBS) |
| 1 | 06-82-0040 | Pad Assembly | 55±10 | 47±8 |
| 2 | 06-81-0028 | Pad Attachment | 40±5 | 34±4 |